

# 1 AQUATIC SITE PLAN 3

SCALE: 3/32" = 1'-0"

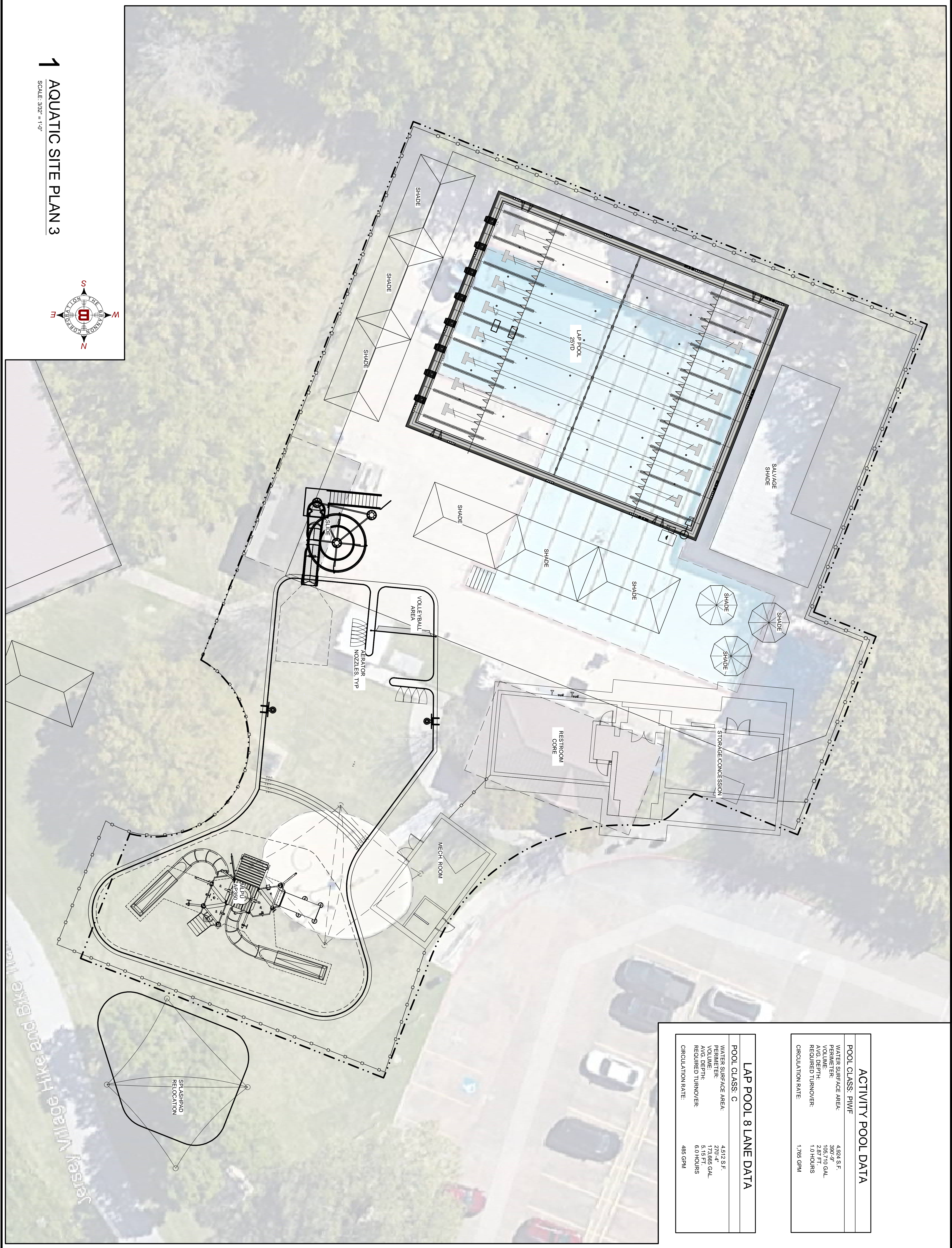
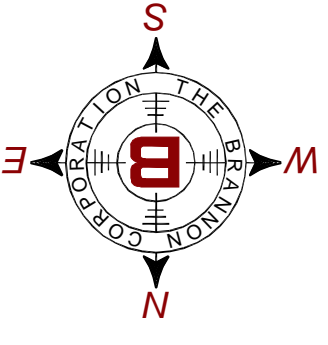

ACTIVITY POOL DATA	
POOL CLASS: PIWF	4,924 S.F.
WATER SURFACE AREA:	390'-9"
PERIMETER:	105,710 GAL.
VOLUME:	287 FT.
AVG. DEPTH:	1.0 HOURS
REQUIRED TURNOVER:	1,765 GPM
CIRCULATION RATE:	

LAP POOL 8 LANE DATA	
POOL CLASS: C	4,512 S.F.
WATER SURFACE AREA:	270'-4"
PERIMETER:	173,865 GAL.
VOLUME:	500 FT.
AVG. DEPTH:	8.0 HOURS
REQUIRED TURNOVER:	485 GPM
CIRCULATION RATE:	

Site Plan Updates.dwg

REVISIONS		
NO.	DATE	REMARKS
1		
1		
1		

**PROGRESSIVE COMMERCIAL POOLS**  
**CITY OF JERSEY VILLAGE**  
 7804 EQUADOR STREET

DESIGNED BY: ###  
 ISSUE DATE: ###